

ELA No. 5678

HOLDER: MT THORLEY OPERATIONS PTY LIMITED

PARISHES: WARKWORTH, WHITTINGHAM, WOLLOMBI & WHYBROW

COUNTIES: NORTHUMBERLAND & HUNTER

SCALE 1: 50000

REF MAP: 9132-4-S

SUBJECT TO SURVEY

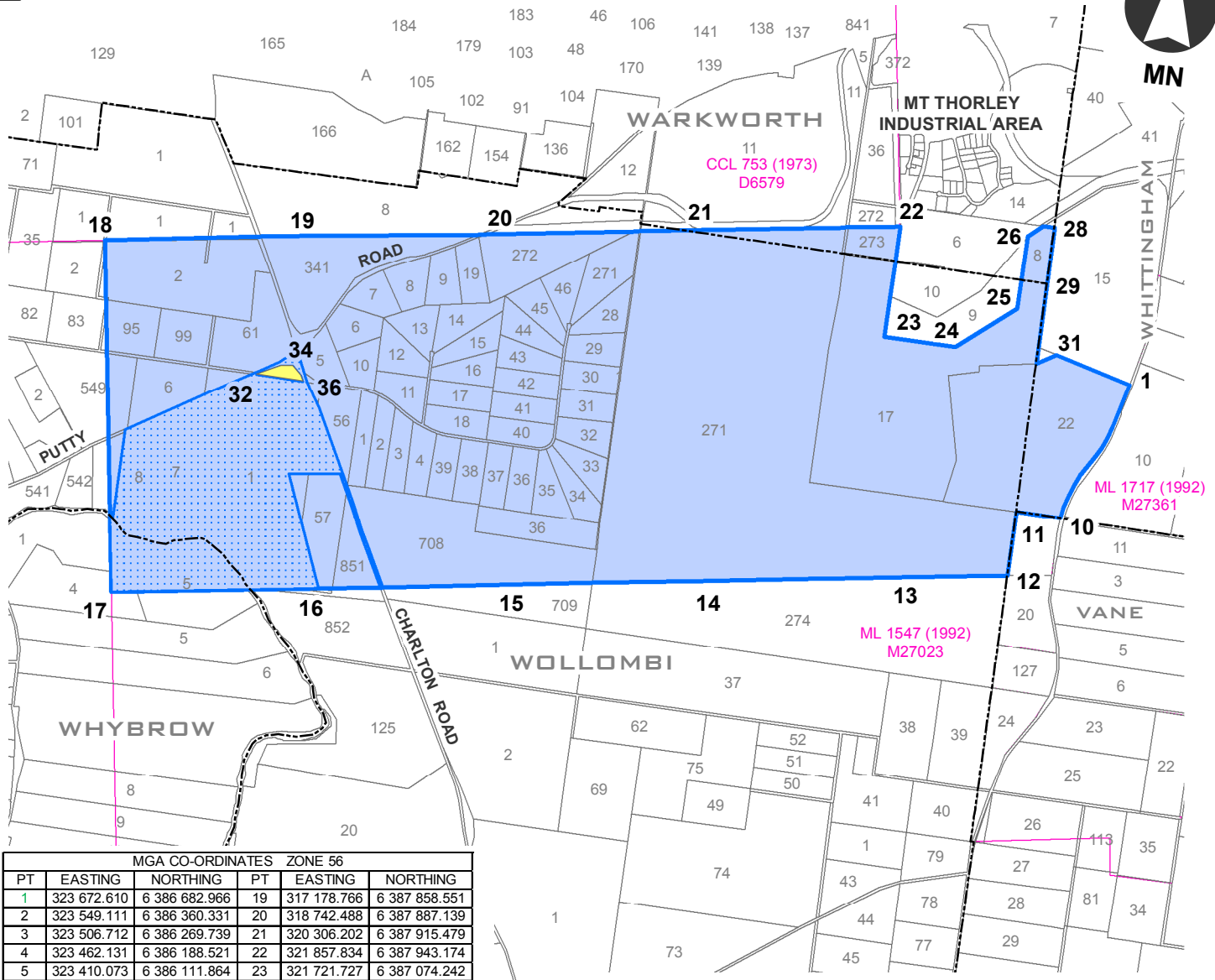

| MGA CO-ORDINATES ZONE 56 |             |               |    |             |               |
|--------------------------|-------------|---------------|----|-------------|---------------|
| PT                       | EASTING     | NORTHING      | PT | EASTING     | NORTHING      |
| 1                        | 323 672.610 | 6 386 682.966 | 19 | 317 178.766 | 6 387 858.551 |
| 2                        | 323 549.111 | 6 386 360.331 | 20 | 318 742.488 | 6 387 887.139 |
| 3                        | 323 506.712 | 6 386 269.739 | 21 | 320 306.202 | 6 387 915.479 |
| 4                        | 323 462.131 | 6 386 188.521 | 22 | 321 857.834 | 6 387 943.174 |
| 5                        | 323 410.073 | 6 386 111.864 | 23 | 321 721.727 | 6 387 074.242 |
| 6                        | 323 299.190 | 6 385 972.135 | 24 | 322 275.747 | 6 386 987.272 |
| 7                        | 323 255.460 | 6 385 898.295 | 25 | 322 768.230 | 6 387 279.828 |
| 8                        | 323 209.142 | 6 385 810.054 | 26 | 322 857.649 | 6 387 849.466 |
| 9                        | 323 171.004 | 6 385 717.605 | 27 | 322 994.945 | 6 387 931.050 |
| 10                       | 323 144.725 | 6 385 631.571 | 28 | 323 082.020 | 6 387 917.700 |
| 11                       | 322 805.962 | 6 385 684.075 | 29 | 323 019.326 | 6 387 484.658 |
| 12                       | 322 729.72  | 6 385 186.06  | 30 | 322 928.693 | 6 386 822.897 |
| 13                       | 321 919.44  | 6 385 171.63  | 31 | 323 084.492 | 6 386 898.942 |
| 14                       | 320 356.18  | 6 385 143.57  | 32 | 316 808     | 6 386 771     |
| 15                       | 318 792.93  | 6 385 115.24  | 33 | 316 999     | 6 386 841     |
| 16                       | 317 229.66  | 6 385 086.52  | 34 | 317 091     | 6 386 842     |
| 17                       | 315 666.36  | 6 385 057.67  | 35 | 317 154     | 6 386 766     |
| 18                       | 315 615.036 | 6 387 829.684 | 36 | 317 173     | 6 386 716     |

Co-ordinate points coloured green determined by survey.  
 Co-ordinate values for:  
 Pts 1 & 10 from M27361  
 Pts 12-17 from M27023

UNIVERSAL TRANSVERSE MERCATOR PROJECTION  
 HORIZONTAL DATUM: GDA94

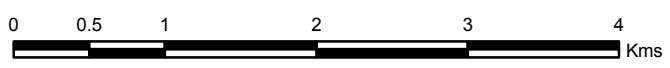

AREA: abt. 1988 ha

- Embraces the strata between a depth of 10 metres below the Bayswater Seam to a depth of 900 metres below Australian Height Datum.
- Embraces the surface and soil below thereof to a depth of 20 metres and then the strata between a depth of 10 metres below the Bayswater Seam to a depth of 900 metres below Australian Height Datum.
- Embraces the surface and soil below thereof to a depth of 20 metres and then the strata from 100 metres below the Australian Height Datum or 30 metres above the Bayswater seam (which ever is deeper) to a depth of 900 metres below Australian Height Datum.

Approved by: P Hord  
 Date: 22-05-2018  
 Drafting Services  
 Operations & Programs

**DISCLAIMER:** The compilation of information shown on this diagram is derived from plans and data, some of which has been produced and provided by third parties. Title boundaries have been adjusted to maintain their relationship with the digital cadastral database in some circumstances, thereby creating certain inaccuracies in the data. The Department and the State of New South Wales make no statement, representation or warranty that the titles information shown on this diagram is complete, accurate or free from error. Users rely on the titles information supplied on this diagram at their own risk. The Department and the State of New South Wales accepts no responsibility for any person, acting on, or relying on, or upon any of the titles information shown on this diagram, and disclaim all liability for any loss, damage, cost, expense or injury (including death) incurred or arising by reason of any person using or relying on the titles information contained on this diagram by reason or by any error, omission, defect or misstatement (whether such error, omission or misstatement is caused by or arises from negligence, lack of care or otherwise). Users should always verify historical material by making and relying upon their own separate inquiries prior to making any important decisions or taking any action on the basis of titles information.